

# 2.0×1.6 SMD TCXO/VC-TCXO

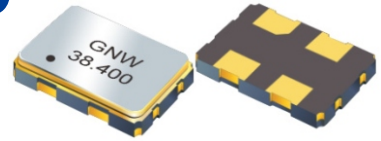

## APPLICATIONS

- GPS / LTE / Femtocell
- Wireless communications/ IoT
- WiMAX/ W-LAN/ Industrial control

## FEATURE

- Wide frequency range
- Low voltage operation
- Low phase noise
- High stability
- Low power consumption



## Electrical Specifications 电气参数

项目	Electrical Specifications	
频率范围	13MHz to 52MHz	
工作电压	1.8V~3.3V	
输出电平	0.8Vp-p min.(Clipped Sinewave)	
输出负载	10KΩ//10pF	
频率稳定度	Tolerance	±2.0ppm max.
	vs Temperature	±0.5ppm ~ ±2.0ppm max.
	vs Supply voltage	±0.1ppm max.(Vcc ±5%)
	vs Load coefficient	±0.1ppm max.
	vs Aging	±1.0ppm/year
工作温度	-40°C~+85°C,or specify	
VC-TCXO	Frequency control range	±8ppm to ±16ppm
	Control voltage range	0.3V~1.5V@1.8V,0.4V~2.4V@2.8V,0.5V~2.5V@3.3V
	Input impedance	500kΩ
功耗	2.0mA max.	
占空比	45% to 55%	
启动时间	2.0ms max.	
储存温度	-40°C ~ +85°C	
相位噪声	-135dBc/Hz	

## Mechanical Dimensions 外型尺寸

Units:mm

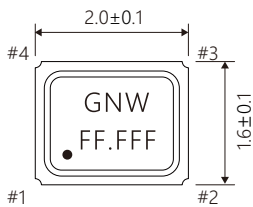

Top View

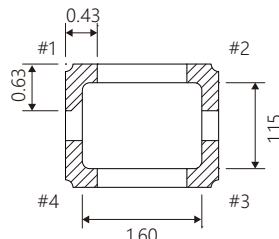

Bottom View

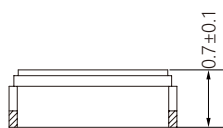

Side View

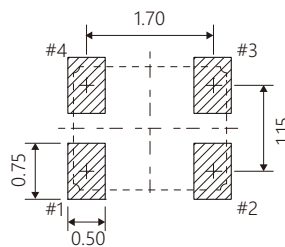

Land Pattern

Pin	Connection	
	VC-TCXO	TCXO
#1	Vcont	GND/N.C.
#2	GND	
#3	Output	
#4	Vcc	